

**GROUND FLOOR PLAN
(REVISED OPTION 1
19-9-2020)**

PROPOSED INTERIOR
FOR CANARA BANK
BRANCH AT
JALANDHAR NIT
BRANCH

- FOR TENDER
- FOR PROPOSAL
- FOR EXECUTION

This drawing is the property of THAPAR ASSOCIATES and shall not be reproduced, copied, loaned over to a third party or used for any purpose other than for which it has been made.

Note:
1. Dimensions on the drawing are to be read, not scaled.
2. Any discrepancy found in the drawing to be immediately clarified with the architect.
3. All drawings are inter-related and shall be read in conjunction with other drawings.



DRAWING NAME
FINAL LAYOUT PLAN

SIGNSTAMP

DEALT:	ATKA
CHECKED:	SAURASH THAPAR
DATE	18-08-2020
SCALE	NTS
LOCATION	
DWG. NO.	

PRINCIPLE ARCHITECT
AR. SAURASH THAPAR

ARCHITECTS
THAPAR ASSOCIATES
ARCHITECTS, INTERIOR & LANDSCAPE DESIGNERS
H.NO. 2017, SECTOR 16-C,
GURGAON-122002

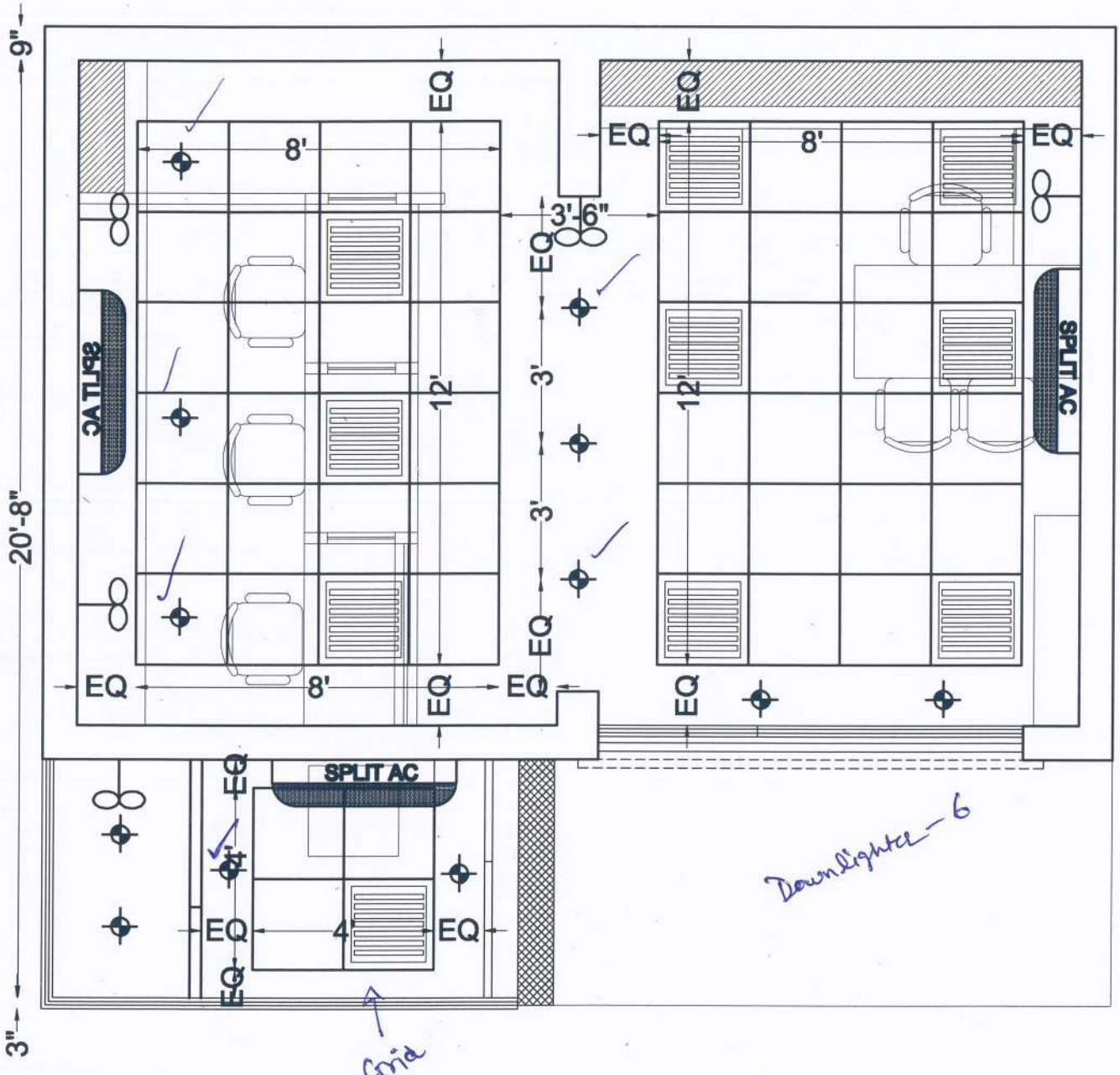

FALSE CEILING PLAN

 **LED DOWN-LIGHTER**
 **CABIN FAN**
 **SPLIT AC**

 **2' X 2'**

PROPOSED INTERIOR FOR CANARA BANK BRANCH AT JALANDHAR NIT BRANCH

- FOR TENDER
- FOR PROPOSAL
- FOR EXECUTION

Note:
 1. Dimensions on the drawing are to be read, not scaled.
 2. Any discrepancy found in the drawing to be immediately clarified with the architect.
 3. All drawings are later-related and shall be read in conjunction with other drawings.



DRAWING NAME
 FINAL LAYOUT PLAN

DEALT:	ATKA
CHECKED:	SAURABH THAPAR
DATE:	18-08-2020
SCALE:	NTS
LOCATION:	
DRG. NO.:	

PRINCIPLE ARCHITECT
 AR. SAURABH THAPAR

ARCHITECTS
 THAPAR ARCHITECTS
 ARCHITECT, INTERIOR & LANDSCAPE DESIGNERS
 100, SBT, SECTOR 19-D, GURGAON - 122002

This drawing is the property of THAPAR ARCHITECTS and shall not be reproduced, copied, loaned over to a third party or used for any purpose other than for which it has been issued.